



Project: Roof Replacement & Related Work
CLARA BARTON ELEMENTARY SCHOOL
Philadelphia, PA

Client: School District of Philadelphia
Philadelphia, PA

Contractor: DA Nolt, Inc
Berlin, New Jersey

Assembly: Various assemblies including Modified Bitumen and Asphaltic shingles.

Completion: Fall, 2000

Cost: \$ 381,000

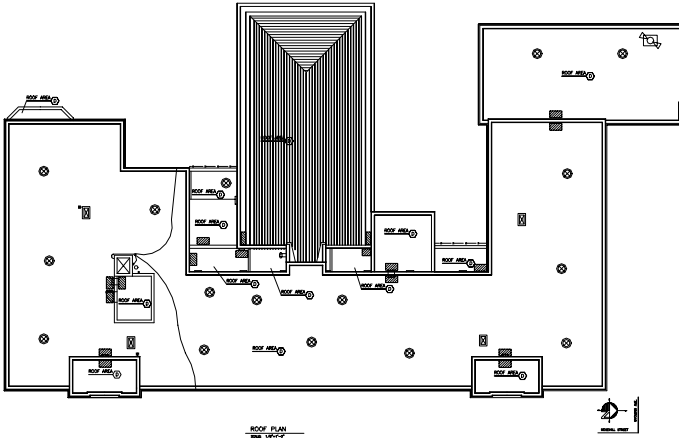

CLARA BARTON ELEMENTARY SCHOOL



Comment: Remove the existing roofing systems including flashings and other roofing accessories. Replace with new modified bitumen and asphalt shingle roofing assemblies, including flashings and roofing accessories. Extensive masonry restoration and related work accompanied this project.

